

JARO 37

A NEW WAY OF NAVIGATE

COUPE DESIGN
YACHT

WWW.COUPEYACHTDESIGN.COM

JARO 37

JARO 37' COUPÉ IS THE YACHT FOR THE OWNER WHO HAS A WISH

- TO HAVE THE YACHT IN THE CLOSEST PORT BUT NOT BE OBLIGED TO SAIL IN THE CLOSEST WATER.
- TO ENJOY SAILING BUT TO HAVE POWERFUL ENGINE ABLE TO DRIVE HIM FAST IN SAFETY BAY WHEN NECESSARY.
- TO SPENT HIS HOLIDAY WITH HIS LOVELY SAILYACHT BUT TO MOVE FAST TO VACATION DESTINATION

IT'S A LIGHT SAIL YACHT ABLE TO SAIL WITH GOOD PERFORMANCE GOING UPWIND AND WITH MORE AND MORE INTERESTING PERFORMANCE TURNING DOWN WIND. ALL RUNNING RIGGING ARE DRIVEN TO MAIN COCKPIT IN WAY OF BEING ALWAYS EASILY MANAGED

STAYSAIL IS A SELF TACKING JIB, WITH A TRACK INTEGRATED IN THE COACH ROOF AND IT'S ALSO A POWERFULL 110% JIB WITH A FIXED POINT SERVED BY A BARBER. IN BOTH CASE TACK POINT IS ATTACHED TO A FURLER WITH THE DRUM HIDDEN BELOW DECK . A CARBON BOWSPRINT, WITH A FULL LENGHT OF OVER 1,2 M IS ATTACHED TO THE BOW AND IT HIDES THE ANCHOR SYSTEM

HULL HAS ROUND SIDE AND A V BOTTM, VERY DEEP IN THE BOW. THERE'S A SPRAY RAIL THAT BECOME WIDER FROM BOW TO STERN. TRANSOM IS A FLAT AND VERTICAL AND IT HOLD 2 RUDDER BLADES AND INTERCEPTORS. INTERCEPTORS HAVE A BIG INFLUENCE WHILE SURFING AND POSITIVE EFFECT WHILE SAILING.

KEEL FIN HAS A DEEP PROFILE AND TOTAL WEIGHT OF ABOUT 1T KEEL IS CONNECTED TO AN HYDRAULIC SYSTEM THAT PIVOT THE FIN ALLOWING IT TO BE MOSTLY HIDDEN IN THE BOTTOM. WITH KEEL DRAFT IS 2,45M AND WITH THE KEEL UP IT IS ONLY 85CM



WWW.COUPEYACHTDESIGN.COM

INFO@COUPEYACHTDESIGN.COM

MOBILE +39 347 82 86 936

JARO 37

COUPE
DESIGN
YACHT



INTERIORS ARE CHARACTERIZED BY THE WIDE SALON WITH A TOTAL LENGTH OF MORE THAN 3M.

IN THE MIDDLE OF THE SALON THERE IS A WARDROBE THAT HIDE THE BOX OF THE PIVOTING KEEL WITH ITS MECHANISM.

ATTACHED THERE ARE ON STARBOARD A FOLDING TABLE WITH A TOTAL LENGTH OF 1,9M. AND ON PORT SIDE THERE IS A HINGED TABLE.

FORWAED THERE IS THE OWNER CABIN AFT ON PORT SIDE THERE IS THE GUEST CABIN.

A VERY WIDE BATHROOM, 1,3X1M IS PLACED ON STARBOARD, EQUIPPED WITH A SHOWER AND AN ELELECTIC WC/BIDET.

ALL KIND OF FINISHING AND CUSTOMIZATION ARE ALLOWED.

WWW.COUPEYACHTDESIGN.COM

INFO@COUPEYACHTDESIGN.COM

MOBILE +39 347 82 86 936

JARO 37

JARO 37' COUPÉ - MAIN DIMENSIONS

| | |
|-------------------------------|-------------|
| FULL LENGHT | 12,7 M |
| HULL LENGHT | 11,4 M |
| LWL | 10,9 M |
| BEAM MAX | 3,65 M |
| LIGHT SHIP DISPLACEMENT | 5,2 T |
| KEEL WEIGHT | 0,87 T |
| DRAFT IN LIGHT SHIP CONDITION | 0,85/2,45 M |

| | |
|-----------------------|--------|
| MAIN SAIL AREA | 36 M2 |
| SELF TACKING JIB AREA | 29 M2 |
| 110% JIB AREA | 35 M2 |
| GENNAKER AREA | 112 M2 |

| | |
|-------------------------|------------------|
| ENGINE: | 200/147 HP/KW |
| PORPELLER | VP AQUAMATIC DPS |
| FUEL TANK | 271 L |
| BLACK & GREY WATER TANK | 40 L |
| FRESH WATER TANK | 120 L |
| GAS TANK | 3 KG |
| SERVICE BATTERY | 3X130 AH |
| ENGINE BATTERY | 90 AH |
| ELECTRIC SYSTEM VOLTAGE | 12VCC-220V CA |

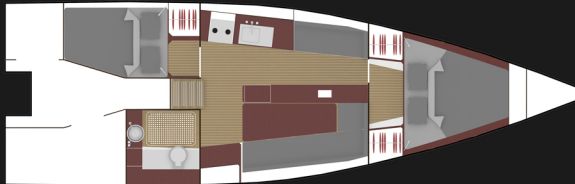

WWW.COUPEYACHTDESIGN.COM

INFO@COUPEYACHTDESIGN.COM

MOBILE +39 347 82 86 936